

This 2 1/4"-2 single lead acme machine screw is available in both alloy steel and stainless steel with a corresponding aluminum bronze nut. Choose from right-hand or left-hand threads.

MACHINE SCREW SPECIFICATIONS	RH	LH
ALLOY STEEL SCREW PART NO.	AS 225 R 050 A	AS 225 L 050 A
STAINLESS STEEL SCREW PART NO.	AS 225 R 050 S	AS 225 L 050 S
THREAD FORM	ACME	
SCREW DIAMETER - TPI	2 1/4" - 2	
PITCH/LEAD	0.500 IN.	
ROOT DIAMETER	1.685 IN.	
SCREW WEIGHT (LB./FT.)	10.6	
TORQUE TO RAISE 1 POUND	.211 IN.-LB.	
MAXIMUM SCREW LENGTH	20 FEET *	

* 12 feet for stainless steel stock

Nut and Flange Specifications

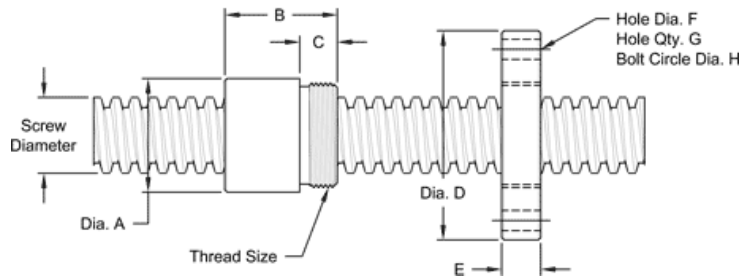

NUT SPECIFICATIONS	RH	LH
NUT PART NUMBER	AN 225 R 050 B	AN 225 L 050 B
NUT WITH FLANGE	AF 225 R 050	AF 225 L 050
DYNAMIC LOAD CAPACITY (LBS.)	30,000	
STATIC LOAD CAPACITY (LBS.)	81,000	
EFFICIENCY	38.7%	
MATERIAL	BRONZE	
NOMINAL DIAMETER "A"	3.38 IN.	
NUT LENGTH "B"	3.06 IN.	
THREAD LENGTH "C"	1.560 IN.	
THREAD SIZE	3.137-12 UN	
FLANGE PART NUMBER	FL-3137	
FLANGE DIAMETER "D"	5.38 IN	
FLANGE THICKNESS "E"	1.580 IN.	
FLANGE HOLE DIAMETER "F"	0.656 IN.	
NUMBER OF HOLES IN FLANGE "G"	6	
FLANGE BOLT CIRCLE "H"	4.375 IN.	
FLANGE MATERIAL	BLACK OXIDE COATED STEEL	