

This 3 3/8"-1 1/2 single lead stub acme machine screw is available in both alloy steel and stainless steel with a corresponding aluminum bronze nut. Choose from right-hand or left-hand threads.

MACHINE SCREW SPECIFICATIONS	RH	LH
ALLOY STEEL SCREW PART NO.	SS 338 R 067 A	SS 338 L 067 A
STAINLESS STEEL SCREW PART NO.	SS 338 R 067 S	SS 338 L 067 S
THREAD FORM	STUB ACME	
SCREW DIAMETER - TURNS/INCH	3 3/8" -1 1/2	
PITCH/LEAD	0.667 IN.	
ROOT DIAMETER	2.902 IN.	
SCREW WEIGHT (LB./FT.)	20.1	
TORQUE TO RAISE 1 POUND	0.314 IN.-LB.	
MAXIMUM SCREW LENGTH	20 FEET*	

* 12 feet for stainless steel stock

Nut and Flange Specifications

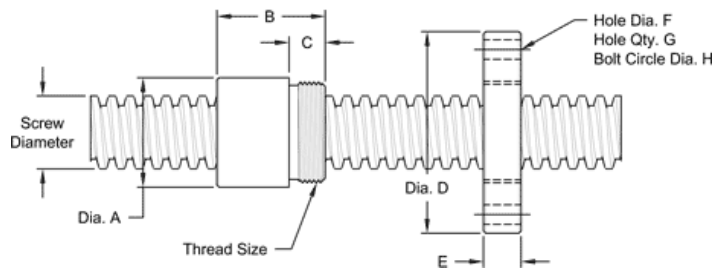

NUT SPECIFICATIONS	RH	LH
NUT PART NUMBER	SN 338 R 067 B	SN 338 L 067 B
NUT WITH FLANGE	SF 338 R 067	SF 338 L 067
DYNAMIC LOAD CAPACITY (LBS.)	40,000	
STATIC LOAD CAPACITY (LBS.)	100,000	
EFFICIENCY	34.7%	
MATERIAL	BRONZE	
NOMINAL DIAMETER "A"	4.50 IN.	
NUT LENGTH "B"	4.50 IN.	
THREAD LENGTH "C"	2.00 IN.	
THREAD SIZE	4.325-12 UN	
FLANGE PART NUMBER	FL-4325	
FLANGE DIAMETER "D"	7.38 IN	
FLANGE THICKNESS "E"	2.020 IN.	
FLANGE HOLE DIAMETER "F"	0.781 IN.	
NUMBER OF HOLES IN FLANGE "G"	6	
FLANGE BOLT CIRCLE "H"	6.250 IN.	
FLANGE MATERIAL	BLACK OXIDE COATED STEEL	