

This 6"-1 1/3 single lead acme machine screw is available in both alloy steel and stainless steel with a corresponding aluminum bronze nut. This is available with right-hand or left-hand threads.

MACHINE SCREW SPECIFICATIONS	RH	LH
ALLOY STEEL SCREW PART NO.	AS 600 R 075 A	AS 600 L 075 A
STAINLESS STEEL SCREW PART NO.	AS 600 R 075 S	AS 600 L 075 S
THREAD FORM	ACME	
SCREW DIAMETER - TURNS/INCH	6" - 1 1/3	
PITCH/LEAD	0.750 IN.	
ROOT DIAMETER	5.169 IN.	
SCREW WEIGHT (LB./FT.)	87	
TORQUE TO RAISE 1 POUND	0.485 IN.-LB.	
MAXIMUM SCREW LENGTH	20 FEET*	

*12 feet for stainless steel stock

Nut and Flange Specifications

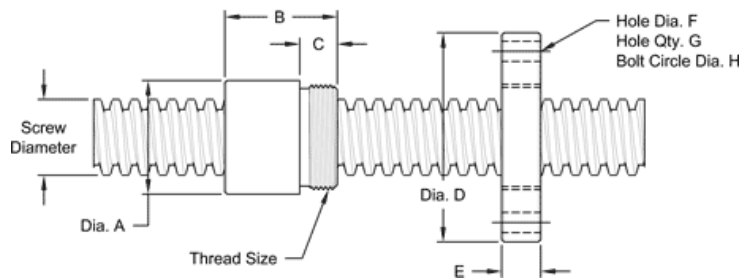

NUT SPECIFICATIONS	RH	LH
NUT PART NO.	AN 600 R 075 B	AN 600 L 075 B
NUT WITH FLANGE PART NO.	AF 600 R 075	AF 600 L 075
DYNAMIC LOAD CAPACITY (LBS.)	150,000	
STATIC LOAD CAPACITY (LBS.)	470,000	
EFFICIENCY	25.4%	
MATERIAL	BRONZE	
NOMINAL DIAMETER "A"	8.00 IN.	
NUT LENGTH "B"	7.00 IN.	
THREAD LENGTH "C"	2.000 IN.	
THREAD SIZE	7.847-8 UN	
FLANGE PART NUMBER	FL-7847	
FLANGE DIAMETER "D"	14.00 IN	
FLANGE THICKNESS "E"	2.020 IN.	
FLANGE HOLE DIAMETER "F"	1.125 IN.	
NUMBER OF HOLES IN FLANGE "G"	6	
FLANGE BOLT CIRCLE "H"	12.000 IN.	
FLANGE MATERIAL	BLACK OXIDE COATED STEEL	